

## 1t - 5t

**Shell:** Light aluminum alloy shell shall be adopted which is light but hard and fit for the use in the terrible work environment with a high heat dissipation rate and all tightness design.

**Inverse phase sequence protecting device:** It is the special electrical installation which control the circuit not to work in case of wiring error in the power supply.

**Limit switch:** The limit switch device is installed where the weight is lifted on and off to make the motor to stop automatically so as to prohibit the chains from exceeding for safety.

**24V/36V device:** It is used to prohibit the emergencies from occurring in case of the leakage in the switch.

**Side magnetic braking device:** This device shall realize the instant brake in case of the power dump.

**Chain bag:** It shall be light, handsome and durable.

**Chain:** The chain shall adopt the imported FEC80 ultra heat-treatable Alloy steel chain.

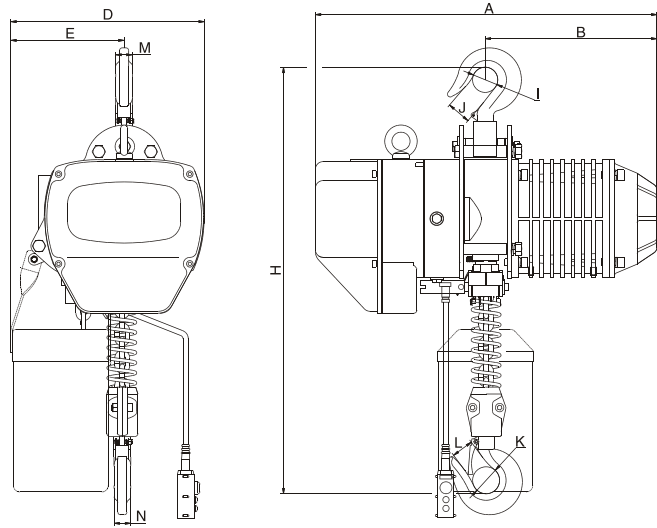

## Hoist with the Hook

### Technical Parameters

Type	Capacity (Ton)	Lifting Speed (m/min)	Lifting motor					Operating motor					I-Beam (mm)	
			Power (Kw)	Rotation speed (r/min)	Phases	Voltage (V)	Frequency (Hz/s)	Power (Kw)	Rotation speed (r/min)	Operating speed (m/min)	Phases	Voltage (V)		Frequency (Hz/s)
01-01	1	6.6	1.5	1440	3	380	50	\	\	\	\	\	\	\
02-01	2	6.6	3.0	1440	3	380	50	\	\	\	\	\	\	\
02-02	2	3.3	1.5	1440	3	380	50	\	\	\	\	\	\	\
03-01	3	5.4	3.0	1440	3	380	50	\	\	\	\	\	\	\
03-02	3	4.4	3.0	1440	3	380	50	\	\	\	\	\	\	\
05-02	5	2.7	3.0	1440	3	380	50	\	\	\	\	\	\	\

### Size specification

Type	capacity (Ton)	Unit (mm)											
		H	A	B	D	E	I	J	K	L	M	N	Chain
01-01	1	650	520	260	300	176	φ 42	32	φ 42	32	24	24	φ 7.1
02-01	2	800	615	295	430	265	φ 49	40	φ 49	40	30	30	φ 10.0
02-02	2	835	520	260	300	236	φ 49	40	φ 49	40	30	30	φ 7.1
03-01	3	845	615	295	430	265	φ 59	48	φ 59	48	35	35	φ 11.2
03-02	3	950	615	295	430	320	φ 59	48	φ 59	48	35	35	φ 10.0
05-02	5	1030	615	295	430	325	φ 60	48	φ 60	48	43	43	φ 11.2

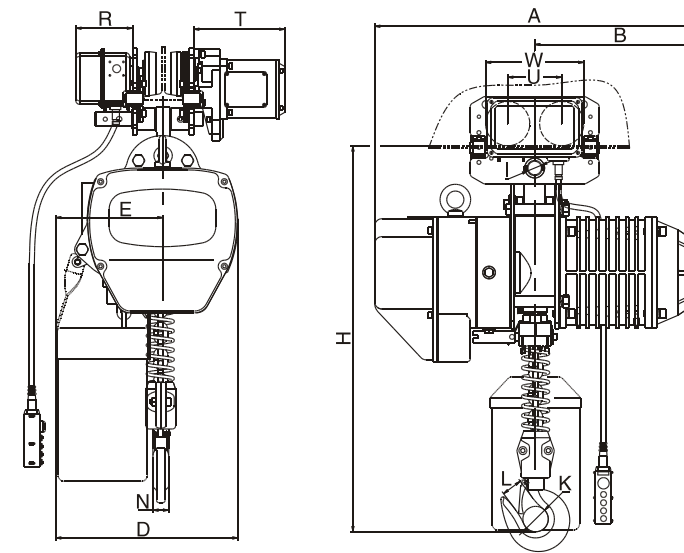

## Hoist with Electric Trolley

### Technical Parameters

Type	Capacity (Ton)	Lifting Speed (m/min)	Lifting motor					Operating motor					I-Beam (mm)	
			Power (Kw)	Rotation speed (r/min)	Phases	Voltage (V)	Frequency (Hz/s)	Power (Kw)	Rotation speed (r/min)	Operating speed (m/min)	Phases	Voltage (V)		Frequency (Hz/s)
01-01	1	6.6	1.5	1440	3	380	50	0.4	1440	11/21	3	380	50	58-153
02-01	2	6.6	3.0	1440	3	380	50	0.4	1440	11/21	3	380	50	82-178
02-02	2	3.3	1.5	1440	3	380	50	0.4	1440	11/21	3	380	50	82-178
03-01	3	5.4	3.0	1440	3	380	50	0.75	1440	11/21	3	380	50	100-178
03-02	3	4.4	3.0	1440	3	380	50	0.75	1440	11/21	3	380	50	100-178
05-02	5	2.7	3.0	1440	3	380	50	0.75	1440	11/21	3	380	50	100-178

### Size specification

Type	capacity (Ton)	Unit (mm)													
		H	A	B	D	E	I	K	L	N	W	U	R	T	Chain
01-01	1	650	520	260	300	176	φ 31	φ 42	32	24	206	111	142	231	φ 7.1
02-01	2	770	615	295	430	265	φ 36	φ 49	40	30	237	127	142	231	φ 10.0
02-02	2	815	520	260	300	236	φ 36	φ 49	40	30	237	127	142	231	φ 7.1
03-01	3	830	615	295	430	265	φ 43	φ 59	48	35	265	140	142	231	φ 11.2
03-02	3	930	615	295	430	320	φ 43	φ 59	48	35	265	140	142	231	φ 10.0
05-02	5	1015	615	295	430	325	φ 54	φ 60	48	43	296	156	142	231	φ 11.2

## 7.5t

**Shell:** Light aluminum alloy shell shall be adopted which is light but hard and fit for the use in the terrible work environment with a high heat dissipation rate and all tightness design.

**Inverse phase sequence protecting device:** It is the special electrical installation which control the circuit not to work in case of wiring error in the power supply.

**Limit switch:** The limit switch device is installed where the weight is lifted on and off to make the motor to stop automatically so as to prohibit the chains from exceeding for safety.

**24V/36V device:** It is used to prohibit the emergencies from occurring in case of the leakage in the switch.

**Side magnetic braking device:** This device shall realize the instant brake in case of the power dump.

**Chain bag:** It shall be light, handsome and durable.

**Chain:** The chain shall adopt the imported FEC80 ultra heat-treatable Alloy steel chain.

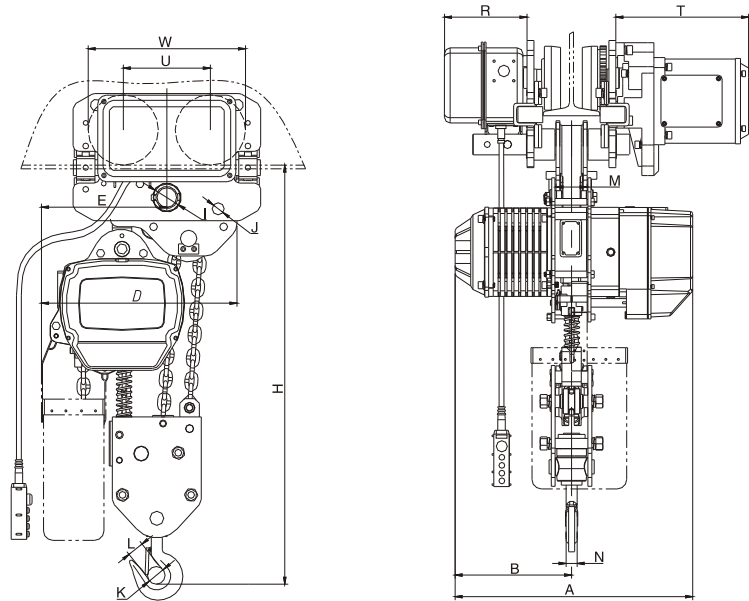

### Hoist with Electric Trolley

#### Technical Parameters

Type	Capacity (Ton)	Lifting Speed (m/min)	Lifting motor					Operating motor					I-Beam (mm)	
			Power (Kw)	Rotation speed (r/min)	Phases	Voltage (V)	Frequency (Hz/s)	Power (Kw)	Rotation speed (r/min)	Operating speed (m/min)	Phases	Voltage (V)		Frequency (Hz/s)
7.5-03	7.5	1.8	3.0	1440	3	380	50	0.75	1440	11/21	3	380	50	100-178

#### Size specification

Type	capacity (Ton)	Unit (mm)														Chain	
		H	A	B	D	E	I	J	K	L	M	N	W	U	R		T
7.5-03	7.5	1200	615	295	505	320	φ 54	φ 31	φ 85	80	85	55	295	156	142	231	φ 11.2

## 10t

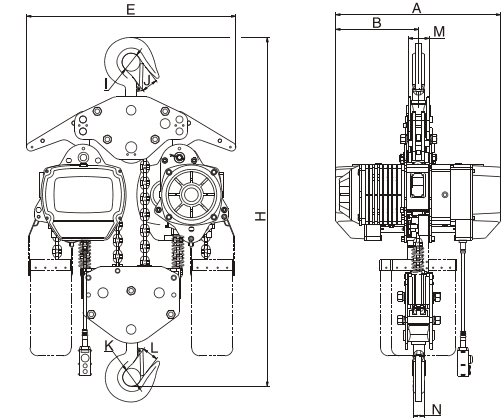

### Hoist with the Hook

#### Technical Parameters

Type	Capacity (Ton)	Lifting Speed (m/min)	Lifting motor					Operating motor					I-Beam (mm)	
			Power (Kw)	Rotation speed (r/min)	Phases	Voltage (V)	Frequency (Hz/s)	Power (Kw)	Rotation speed (r/min)	Operating speed (m/min)	Phases	Voltage (V)		Frequency (Hz/s)
10-04	10	2.7	3.0 × 2	1440	3	380	50	\	\	\	\	\	\	\

#### Size specification

Type	capacity (Ton)	Unit (mm)											Chain
		H	A	B	E	I	J	K	L	M	N		
10-04	10	1400	630	315	890	φ 85	80	φ 85	80	104	55	φ 11.2	

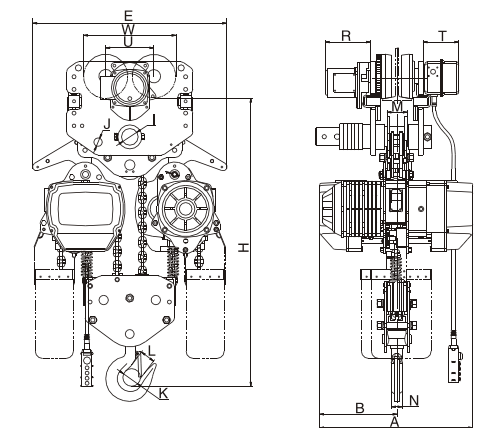

### Hoist with Electric Trolley

#### Technical Parameters

Type	Capacity (Ton)	Lifting Speed (m/min)	Lifting motor					Operating motor					I-Beam (mm)	
			Power (Kw)	Rotation speed (r/min)	Phases	Voltage (V)	Frequency (Hz/s)	Power (Kw)	Rotation speed (r/min)	Operating speed (m/min)	Phases	Voltage (V)		Frequency (Hz/s)
10-04	10	2.7	3.0 × 2	1440	3	380	50	0.75	1440	11/21	3	380	50	150-220

#### Size specification

Type	capacity (Ton)	Unit (mm)														Chain
		H	A	B	E	I	J	K	L	M	N	W	U	R	T	
10-04	10	1190	630	315	890	φ 70	φ 36	φ 85	80	85	55	366	191	231	142	φ 11.2

## 7.5t

**Shell:** Light aluminum alloy shell shall be adopted which is light but hard and fit for the use in the terrible work environment with a high heat dissipation rate and all tightness design.

**Inverse phase sequence protecting device:** It is the special electrical installation which control the circuit not to work in case of wiring error in the power supply.

**Limit switch:** The limit switch device is installed where the weight is lifted on and off to make the motor to stop automatically so as to prohibit the chains from exceeding for safety.

**24V/36V device:** It is used to prohibit the emergencies from occurring in case of the leakage in the switch.

**Side magnetic braking device:** This device shall realize the instant brake in case of the power dump.

**Chain bag:** It shall be light, handsome and durable.

**Chain:** The chain shall adopt the imported FEC80 ultra heat-treatable Alloy steel chain.

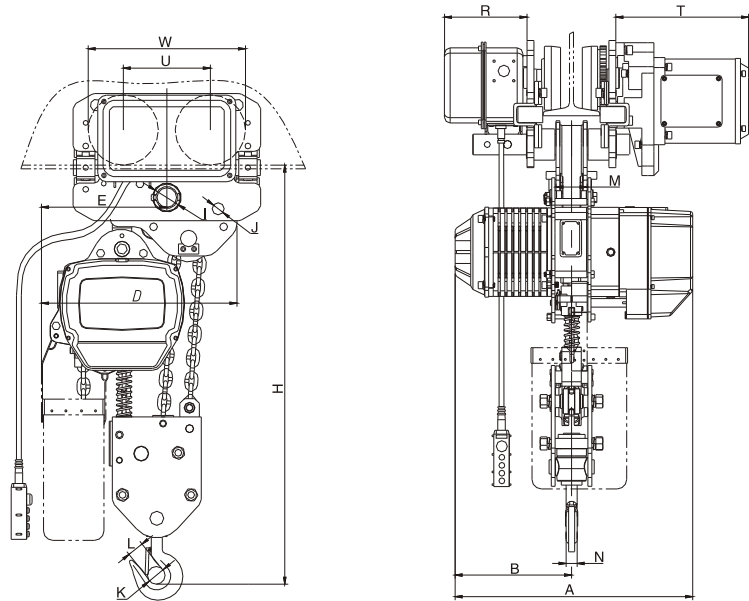

### Hoist with Electric Trolley

#### Technical Parameters

Type	Capacity (Ton)	Lifting Speed (m/min)	Lifting motor					Operating motor					I-Beam (mm)	
			Power (Kw)	Rotation speed (r/min)	Phases	Voltage (V)	Frequency (Hz/s)	Power (Kw)	Rotation speed (r/min)	Operating speed (m/min)	Phases	Voltage (V)		Frequency (Hz/s)
7.5-03	7.5	1.8	3.0	1440	3	380	50	0.75	1440	11/21	3	380	50	100-178

#### Size specification

Type	capacity (Ton)	Unit (mm)															
		H	A	B	D	E	I	J	K	L	M	N	W	U	R	T	Chain
7.5-03	7.5	1200	615	295	505	320	φ 54	φ 31	φ 85	80	85	55	295	156	142	231	φ 11.2

## 10t

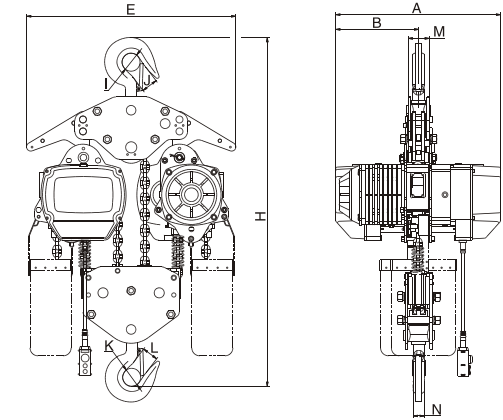

### Hoist with the Hook

#### Technical Parameters

Type	Capacity (Ton)	Lifting Speed (m/min)	Lifting motor					Operating motor					I-Beam (mm)	
			Power (Kw)	Rotation speed (r/min)	Phases	Voltage (V)	Frequency (Hz/s)	Power (Kw)	Rotation speed (r/min)	Operating speed (m/min)	Phases	Voltage (V)		Frequency (Hz/s)
10-04	10	2.7	3.0 × 2	1440	3	380	50	\	\	\	\	\	\	\

#### Size specification

Type	capacity (Ton)	Unit (mm)										
		H	A	B	E	I	J	K	L	M	N	Chain
10-04	10	1400	630	315	890	φ 85	80	φ 85	80	104	55	φ 11.2

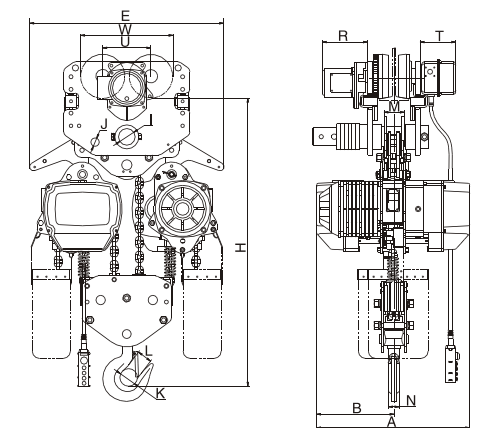

### Hoist with Electric Trolley

#### Technical Parameters

Type	Capacity (Ton)	Lifting Speed (m/min)	Lifting motor					Operating motor					I-Beam (mm)	
			Power (Kw)	Rotation speed (r/min)	Phases	Voltage (V)	Frequency (Hz/s)	Power (Kw)	Rotation speed (r/min)	Operating speed (m/min)	Phases	Voltage (V)		Frequency (Hz/s)
10-04	10	2.7	3.0 × 2	1440	3	380	50	0.75	1440	11/21	3	380	50	150-220

#### Size specification

Type	capacity (Ton)	Unit (mm)														
		H	A	B	E	I	J	K	L	M	N	W	U	R	T	Chain
10-04	10	1190	630	315	890	φ 70	φ 36	φ 85	80	85	55	366	191	231	142	φ 11.2



## 7.5t

**Shell:** Light aluminum alloy shell shall be adopted which is light but hard and fit for the use in the terrible work environment with a high heat dissipation rate and all tightness design.

**Inverse phase sequence protecting device:** It is the special electrical installation which control the circuit not to work in case of wiring error in the power supply.

**Limit switch:** The limit switch device is installed where the weight is lifted on and off to make the motor to stop automatically so as to prohibit the chains from exceeding for safety.

**24V/36V device:** It is used to prohibit the emergencies from occurring in case of the leakage in the switch.

**Side magnetic braking device:** This device shall realize the instant brake in case of the power dump.

**Chain bag:** It shall be light, handsome and durable.

**Chain:** The chain shall adopt the imported FEC80 ultra heat-treatable Alloy steel chain.

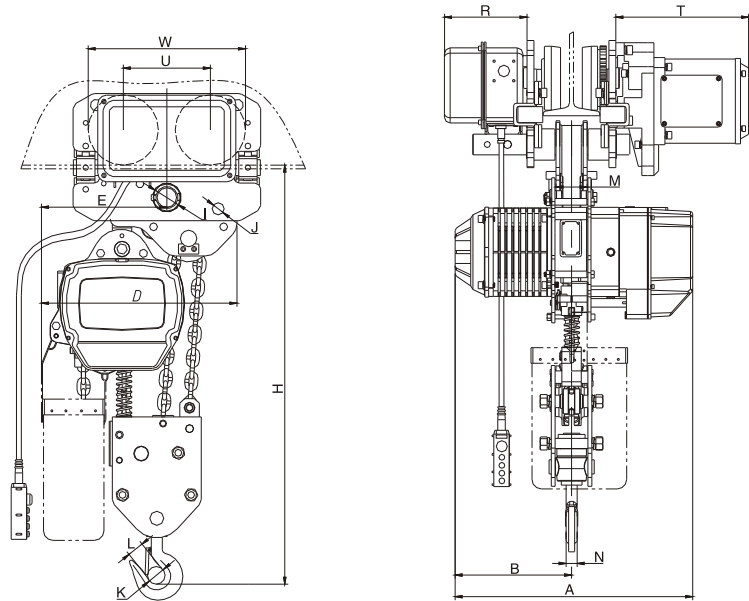

### Hoist with Electric Trolley

#### Technical Parameters

Type	Capacity (Ton)	Lifting Speed (m/min)	Lifting motor					Operating motor					I-Beam (mm)	
			Power (Kw)	Rotation speed (r/min)	Phases	Voltage (V)	Frequency (Hz/s)	Power (Kw)	Rotation speed (r/min)	Operating speed (m/min)	Phases	Voltage (V)		Frequency (Hz/s)
7.5-03	7.5	1.8	3.0	1440	3	380	50	0.75	1440	11/21	3	380	50	100-178

#### Size specification

Type	capacity (Ton)	Unit (mm)															
		H	A	B	D	E	I	J	K	L	M	N	W	U	R	T	Chain
7.5-03	7.5	1200	615	295	505	320	φ 54	φ 31	φ 85	80	85	55	295	156	142	231	φ 11.2

## 10t

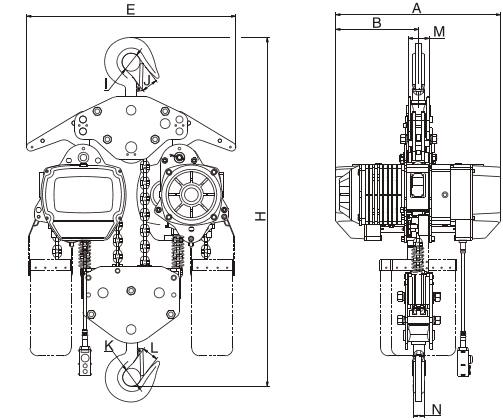

### Hoist with the Hook

#### Technical Parameters

Type	Capacity (Ton)	Lifting Speed (m/min)	Lifting motor					Operating motor					I-Beam (mm)	
			Power (Kw)	Rotation speed (r/min)	Phases	Voltage (V)	Frequency (Hz/s)	Power (Kw)	Rotation speed (r/min)	Operating speed (m/min)	Phases	Voltage (V)		Frequency (Hz/s)
10-04	10	2.7	3.0 × 2	1440	3	380	50	\	\	\	\	\	\	\

#### Size specification

Type	capacity (Ton)	Unit (mm)										
		H	A	B	E	I	J	K	L	M	N	Chain
10-04	10	1400	630	315	890	φ 85	80	φ 85	80	104	55	φ 11.2

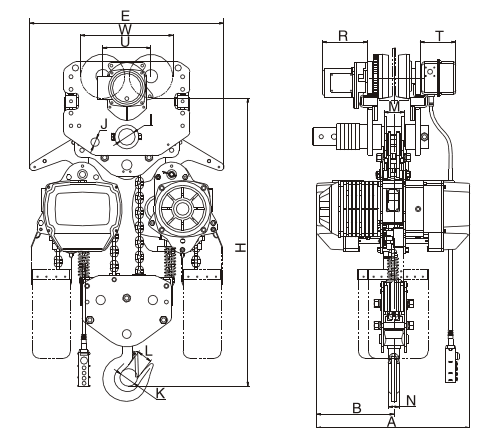

### Hoist with Electric Trolley

#### Technical Parameters

Type	Capacity (Ton)	Lifting Speed (m/min)	Lifting motor					Operating motor					I-Beam (mm)	
			Power (Kw)	Rotation speed (r/min)	Phases	Voltage (V)	Frequency (Hz/s)	Power (Kw)	Rotation speed (r/min)	Operating speed (m/min)	Phases	Voltage (V)		Frequency (Hz/s)
10-04	10	2.7	3.0 × 2	1440	3	380	50	0.75	1440	11/21	3	380	50	150-220

#### Size specification

Type	capacity (Ton)	Unit (mm)														
		H	A	B	E	I	J	K	L	M	N	W	U	R	T	Chain
10-04	10	1190	630	315	890	φ 70	φ 36	φ 85	80	85	55	366	191	231	142	φ 11.2



## 500Kg

**Shell:** Light aluminum alloy shell shall be adopted which is light but hard and fit for the use in the terrible work environment with a high heat dissipation rate and all lightness design.

**Inverse phase sequence protecting device:** It is the special electrical installation which control the circuit not to work in case of wiring error in the power supply.

**Limit switch:** The limit switch device is installed where the weight is lifted on and off to make the motor to stop automatically so as to prohibit the chains from exceeding for safety.

**24V/36V device:** It is used to prohibit the emergencies from occurring in case of the leakage in the switch.

**Side magnetic braking device:** This device shall realize the instant brake in case of the power dump.

**Chain bag:** It shall be light, handsome and durable.

**Chain:** The chain shall adopt the imported FEC80 ultra heat-treatable Alloy steel chain.

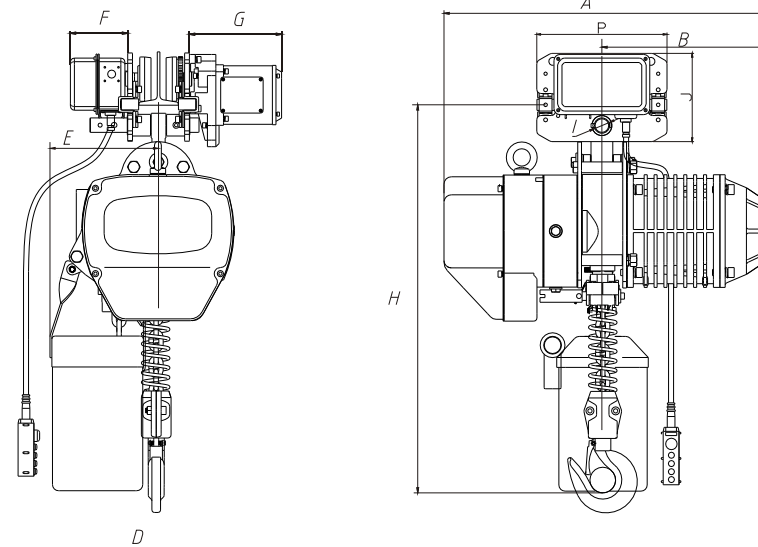
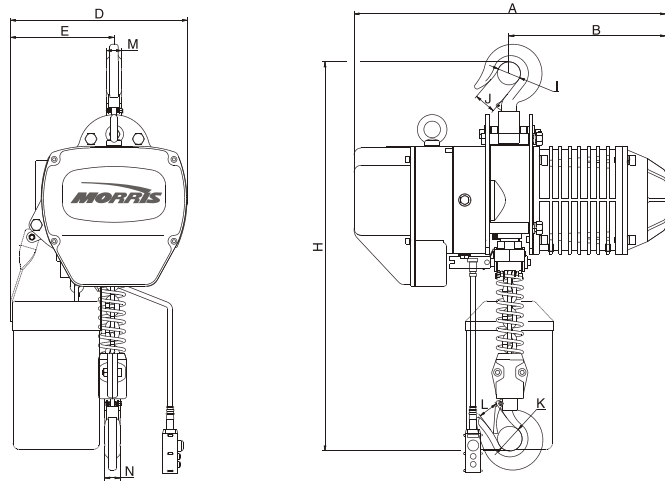

## Hoist with the Hook

### Technical Parameters

Type	Capacity (Ton)	Lifting Speed (m/min)	Lifting motor					Operating motor					I-Beam (mm)	
			Power (Kw)	Rotation speed (r/min)	Phases	Voltage (V)	Frequency (Hz/s)	Power (Kw)	Rotation speed (r/min)	Operating speed (m/min)	Phases	Voltage (V)		Frequency (Hz/s)
0.5-01S	1	7.2	0.75	1440	3	380	50	\	\	\	\	\	\	\
0.5-01D	1	7.2/2.4	0.75/0.27	1440	3	380	50	\	\	\	\	\	\	\

### Size specification

Type	capacity (Ton)	Unit (mm)											
		H	A	B	D	E	I	J	K	L	M	N	Chain
0.5-01S	1	530	460	230	288	178	c 34	28	c 34	28	19	19	c 6.3
0.5-01D	1	530	545	260	288	178	c 34	28	c 34	28	19	19	c 6.3

## Hoist with Electric Trolley

### Technical Parameters

Type	Capacity (Ton)	Lifting Speed (m/min)	Lifting motor					Operating motor					I-Beam (mm)	
			Power (Kw)	Rotation speed (r/min)	Phases	Voltage (V)	Frequency (Hz/s)	Power (Kw)	Rotation speed (r/min)	Operating speed (m/min)	Phases	Voltage (V)		Frequency (Hz/s)
0.5-01S	1	7.2	0.75	1440	3	380	50	0.4	1440	11/21	3	380	50	58-153
0.5-01D	1	7.2/2.4	0.75/0.27	1440	3	380	50	0.4	1440	11/21	3	380	50	82-178

### Size specification

Type	capacity (Ton)	Unit (mm)										
		H	A	B	D	E	P	J	I	F	G	Chain
0.5-01S	1	628	460	230	288	178	315	212	c 31	142	231	c 6.3
0.5-01D	1	628	545	260	288	178	315	212	c 31	142	231	c 6.3

## 500Kg

**Shell:** Light aluminum alloy shell shall be adopted which is light but hard and fit for the use in the terrible work environment with a high heat dissipation rate and all lightness design.

**Inverse phase sequence protecting device:** It is the special electrical installation which control the circuit not to work in case of wiring error in the power supply.

**Limit switch:** The limit switch device is installed where the weight is lifted on and off to make the motor to stop automatically so as to prohibit the chains from exceeding for safety.

**24V/36V device:** It is used to prohibit the emergencies from occurring in case of the leakage in the switch.

**Side magnetic braking device:** This device shall realize the instant brake in case of the power dump.

**Chain bag:** It shall be light, handsome and durable.

**Chain:** The chain shall adopt the imported FEC80 ultra heat-treatable Alloy steel chain.

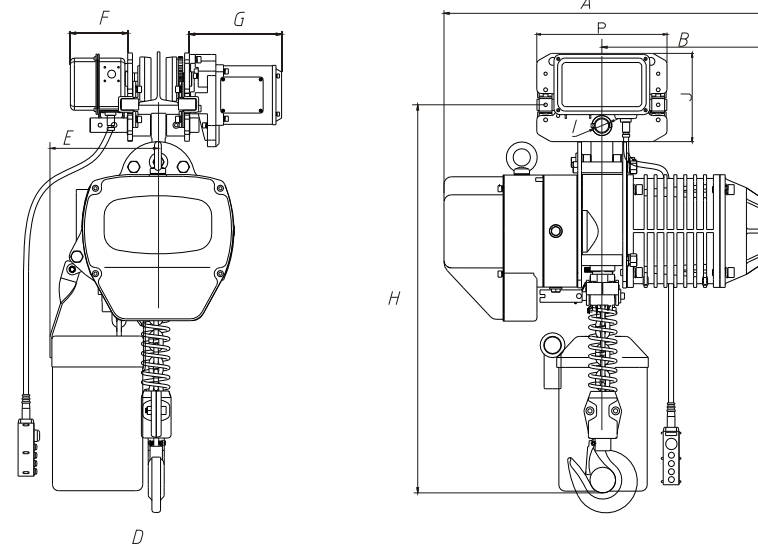
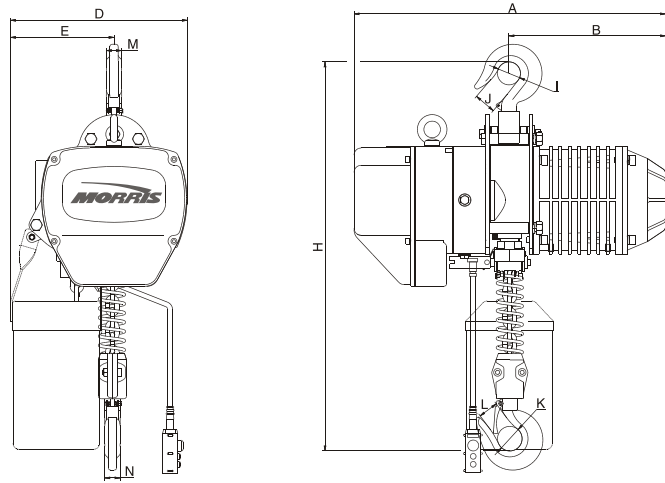

## Hoist with the Hook

### Technical Parameters

Type	Capacity (Ton)	Lifting Speed (m/min)	Lifting motor					Operating motor					I-Beam (mm)	
			Power (Kw)	Rotation speed (r/min)	Phases	Voltage (V)	Frequency (Hz/s)	Power (Kw)	Rotation speed (r/min)	Operating speed (m/min)	Phases	Voltage (V)		Frequency (Hz/s)
0.5-01S	1	7.2	0.75	1440	3	380	50	\	\	\	\	\	\	\
0.5-01D	1	7.2/2.4	0.75/0.27	1440	3	380	50	\	\	\	\	\	\	\

### Size specification

Type	capacity (Ton)	Unit (mm)											
		H	A	B	D	E	I	J	K	L	M	N	Chain
0.5-01S	1	530	460	230	288	178	c 34	28	c 34	28	19	19	c 6.3
0.5-01D	1	530	545	260	288	178	c 34	28	c 34	28	19	19	c 6.3

## Hoist with Electric Trolley

### Technical Parameters

Type	Capacity (Ton)	Lifting Speed (m/min)	Lifting motor					Operating motor					I-Beam (mm)	
			Power (Kw)	Rotation speed (r/min)	Phases	Voltage (V)	Frequency (Hz/s)	Power (Kw)	Rotation speed (r/min)	Operating speed (m/min)	Phases	Voltage (V)		Frequency (Hz/s)
0.5-01S	1	7.2	0.75	1440	3	380	50	0.4	1440	11/21	3	380	50	58-153
0.5-01D	1	7.2/2.4	0.75/0.27	1440	3	380	50	0.4	1440	11/21	3	380	50	82-178

### Size specification

Type	capacity (Ton)	Unit (mm)											
		H	A	B	D	E	P	J	I	F	G	Chain	
0.5-01S	1	628	460	230	288	178	315	212	c 31	142	231	c 6.3	
0.5-01D	1	628	545	260	288	178	315	212	c 31	142	231	c 6.3	

## Manual Trolley

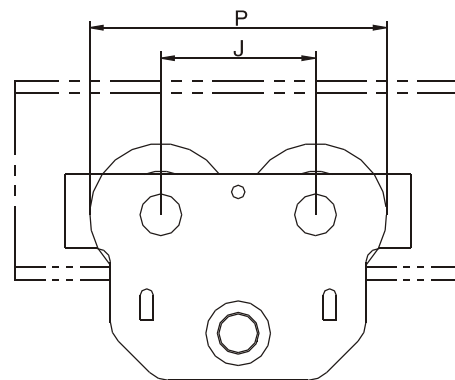
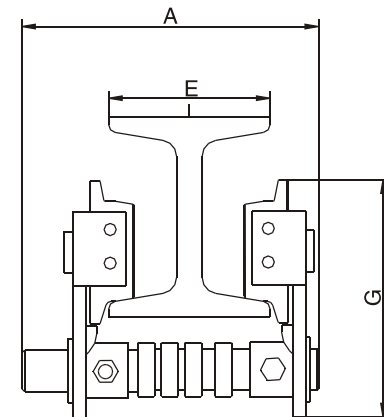

### Size specification

Type	Capacity (Ton)	Unit (mm)					Minimum radius of turn
		A	G	J	E	P	
PC-0.5	0.5	200	130	91	50-102	163	0.6
PC-01	1	200	170	115	50-102	221	1
PC-02	2	218	205	138	68-130	265	1
PC-03	3	275	236	157	82-153	305	1.2
PC-05	5	275	280	178	82-153	332	1.6

## Geared trolley

### Model: SPC-A

### Geared Trolley SPC-A Series

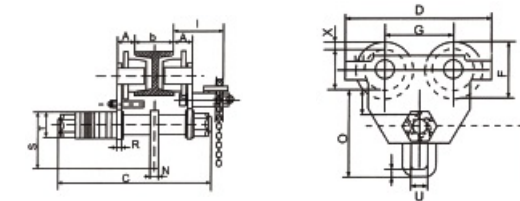

### GEARED TROLLEY SPC-A SERIES SPECIFICATION

Capacity (Ton)	Beam Flange Width (mm)	Dimensions (mm)																Net Weight (Kg)		
		O	A	B	C	D	E	F	G	H	T	R	S	L	X	P	N		U	I
0.5	64-140	128	22	24	230	212	58	82	28	102	44	6	95	15	12	26	10	24	113.5	12
1	64-140	143	25	30	254	255	75	102	118	25	50	8	118	15	13.5	28	12	30.5	112.5	19
2	76-165	172	27	36	294	302	90	122	137	27	60	10	145	20	16	34	14	36	112.5	28
3	76-203	212	31	42	344	344	110	142	157	32	78	12	180	26	16	38	16	45	135	47
5	88-203	254	36	48	360	378	122	156	172	34	90	16	220	35	17	44	20	60	136	58
10	125-203	320	46	60	403	445	151	188	200	35	94	25	285	45	18	48	25	82	160	98
20	144-203	385	68	60	475	642	200	274	300	35	94	30	302	70	37	60	35	110	151.5	185

Notes: the standard length of hand Pulley chain is 3 meters.

### Model: SPC-B

### Geared Trolley SPC-B Series

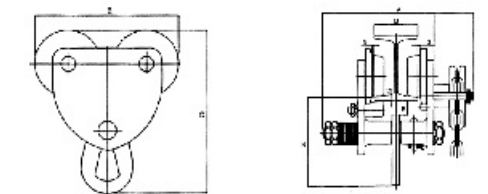

### GEARED TROLLEY SPC-B SERIES SPECIFICATION

Capacity (Ton)	Compatible Rail Size (mm)		Dimensions (mm)											Min. Rotation Radius (mm)	N/W (kg)
	Width (W)		Height (H)		A	B	C	D	E	F	K				
	Min.	Max.	Min.	Max.											
1	75	125	125	250	206	231	120	45	80	27	117	1300	14.0		
2	100	150	150	400	241	271	155	60	100	33	119	1500	23.5		
3	100	150	180	400	261	311	185	70	113	47	134	2000	33.5		
5	125	175	250	450	294	351	220	80	125	53	134	2600	53.5		
10	150	175	250	450	294	721	165	-	125	53	134	-	101.0		

Notes: the standard length of hand Pulley chain is 3 meters.